

Big shower

After you unpack the product, please check the accessories in the following table and figure.
If there is a shortage, please contact customer service immediately.

Product introduction

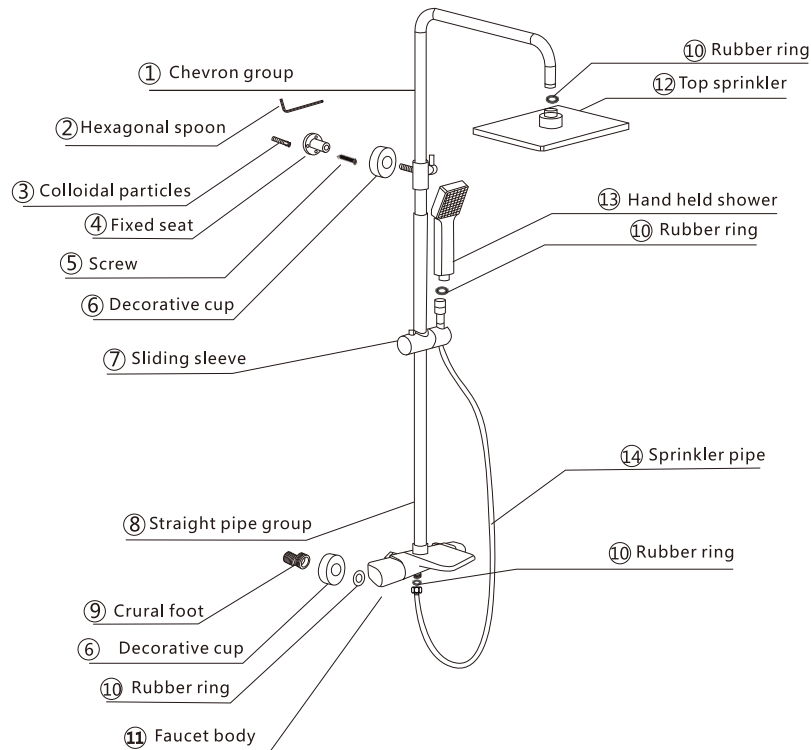

Open shower							
Serial number	Quantity	Serial number	Quantity	Serial number	Quantity	Serial number	Quantity
①	1	⑤	3	⑨	2	⑬	1
②	1	⑥	3	⑩	5	⑭	1
③	3	⑦	1	⑪	1		
④	1	⑧	1	⑫	1		

Big shower

After you unpack the product, please check the accessories in the following table and figure.
If there is a shortage, please contact customer service immediately.

Installation steps

1. Wrap the bent foot with the raw material belt and connect it with the embedded water pipe in the wall (Note: ① the length of the bent foot exposed to the wall should be consistent and vertical to the wall, otherwise there is the possibility of water leakage; ② the connection of the cold and hot water inlet pipe must be accurate, otherwise the tap cannot be used normally).

2. Install the curved foot cup onto the curved foot on the wall and rotate it to fit the wall.

3. Measure the installation position of the fixed base according to the actual size of the product, drill holes on the wall after marking, and punch the self tapping rubber particles into the holes, then fix the fixed base on the wall with self tapping screws, and then cover the decorative cover after it is fixed.

4. Install the washer into the nut, then connect the main body group with the bent foot, tighten the nut with a wrench, insert the fixed seat on the rising rod into the fixed seat on the wall, and tighten it with a hexagonal wrench after adjusting the position. If the position of the product is slightly out of alignment during installation, the partial bath pipe support can be adjusted appropriately.

5. Note: when the top nozzle will rise due to excessive water pressure, please use the auxiliary rotating handle to lock it until the top nozzle will not rise again, especially remind not to use too much force, otherwise the top nozzle will be deformed.

6. Sprinkle the top spray onto the outlet elbow to ensure the connection is firm; Then connect the faucet main body and the portable sprinkler with the sprinkler chain.

7. The lifting method of the rising stem is to loosen the handle on the side of the fixed seat group on the rising stem to adjust the height of the rising stem, and lock the handle after adjustment.

8. After the product is installed, operate according to the test method in Item 7 of the catalog, check the operation of the top spray sprinkler and the hand-held sprinkler, and check the water outlet of the top spray sprinkler and the hand-held sprinkler (Note: please check the use method for the switching mode of the top spray sprinkler and the hand-held sprinkler).